

Reverse Engineering Solutions for I&C, Mechanical and Electrical Products

Minimize Costs of Obsolescence and Lower Risk

With more than 40 years of experience as a nuclear supplier, AREVA offers the best value, highest reliability and industry-leading quality in reverse engineering services for instrumentation & controls (I&C), mechanical and electrical spares. Our rigorous approach to establishing design authority aligns with regulatory guidelines, and our processes were noted as a strength in a recent NUPIC audit.

Customer Problem

For the nuclear industry, procuring replacement parts is an increasing challenge as traditional suppliers exit the marketplace. In addition, utilities with nuclear assets face growing economic pressures to reduce spending and to maximize the value of current investments.

Solution

AREVA can help resolve these conflicting burdens through a full set of reverse engineering techniques and capabilities to design and supply safety-related, augmented quality or non-safety-related equipment even when the original supplier is no longer available. Reverse engineering is a key solution that enables our customers to identify, design and manufacture replacement spare parts for existing equipment or to implement modifications to install new replacement equipment. AREVA is the only NSSS supplier that offers a full range of I&C, mechanical and electrical reverse engineering capabilities.

Ideal for replacing obsolete components, reverse engineered (or re-engineered) components require specialized expertise with strong knowledge of nuclear systems to develop and supply replacement components. In some cases, re-engineering the original component is necessary to meet the facility's unique requirements.

Panel Boards

Before



After



Off-gas System

Before



After



Capabilities

AREVA's experts stand ready to evaluate and to identify solutions. AREVA's I&C, mechanical and electrical reverse engineering capabilities include:

- Design Engineering Services (I&C, mechanical and electrical)
- Metrology Services (3D scanning and modeling)
- Qualification and Dedication Services
- Chemistry and Materials Center
- Machining and Fabrication Services

Benefits

- Eliminates frustration of dealing with suppliers of obsolete parts
- Yields long-term spare part solution for future plant maintenance needs
- Avoids the costs, challenges and risks of modernization projects
- Leverage our plant design, reverse engineering and operation experience to define the optimum solutions
- Allows plant staff to focus on high priority and emergent issues
- Replacement parts are available through AREVA's Nuclear Parts Center with 24/7/365 stocking
- Components can be offered under AREVA's Appendix B program
- AREVA team approach allows for desired system functionality and effective development efforts to be identified early in the design phase
- Services include equivalency determinations and/or design change packages, as required
- AREVA is actively engaged with EPRI to develop industry guidance

Mission

Our solutions are aligned with your goals for safe, reliable and cost-effective operations. Our mission is to provide the best engineering resources to deliver safe, world-class project performance, total cost certainty and excellence in engineering projects. We strive for operational excellence by focusing on safety, quality, performance and delivery of innovative products and services to meet your needs.

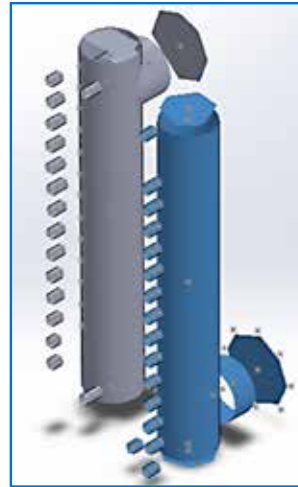

3D scan of the original coil header which was used to pull dimensions and generate fabrication drawings.

Air Handling Unit Coil Header

Before

After



Scan to view our parts on the web:
www.aveva-np.com/cisweb

For more information, please contact:

Charles Lakeman
Business Manager
Nuclear Parts and Procurement
Tel: 704.805.2380

NPC In-stock Parts:
<http://www.us.aveva-np.com/cisweb>

aveva-np.com

The data and information contained herein are provided solely for illustration and informational purposes and create no legal obligations by AREVA. None of the information or data is intended by AREVA to be a representation or a warranty of any kind, expressed or implied, and AREVA assumes no liability for the use of or reliance on any information or data disclosed in this document. ©2017 AREVA Inc. All rights reserved.